

# **QUICKFLIP INSTALLATION INSTRUCTIONS**

---

**CONVERSION KIT (#4309C)**

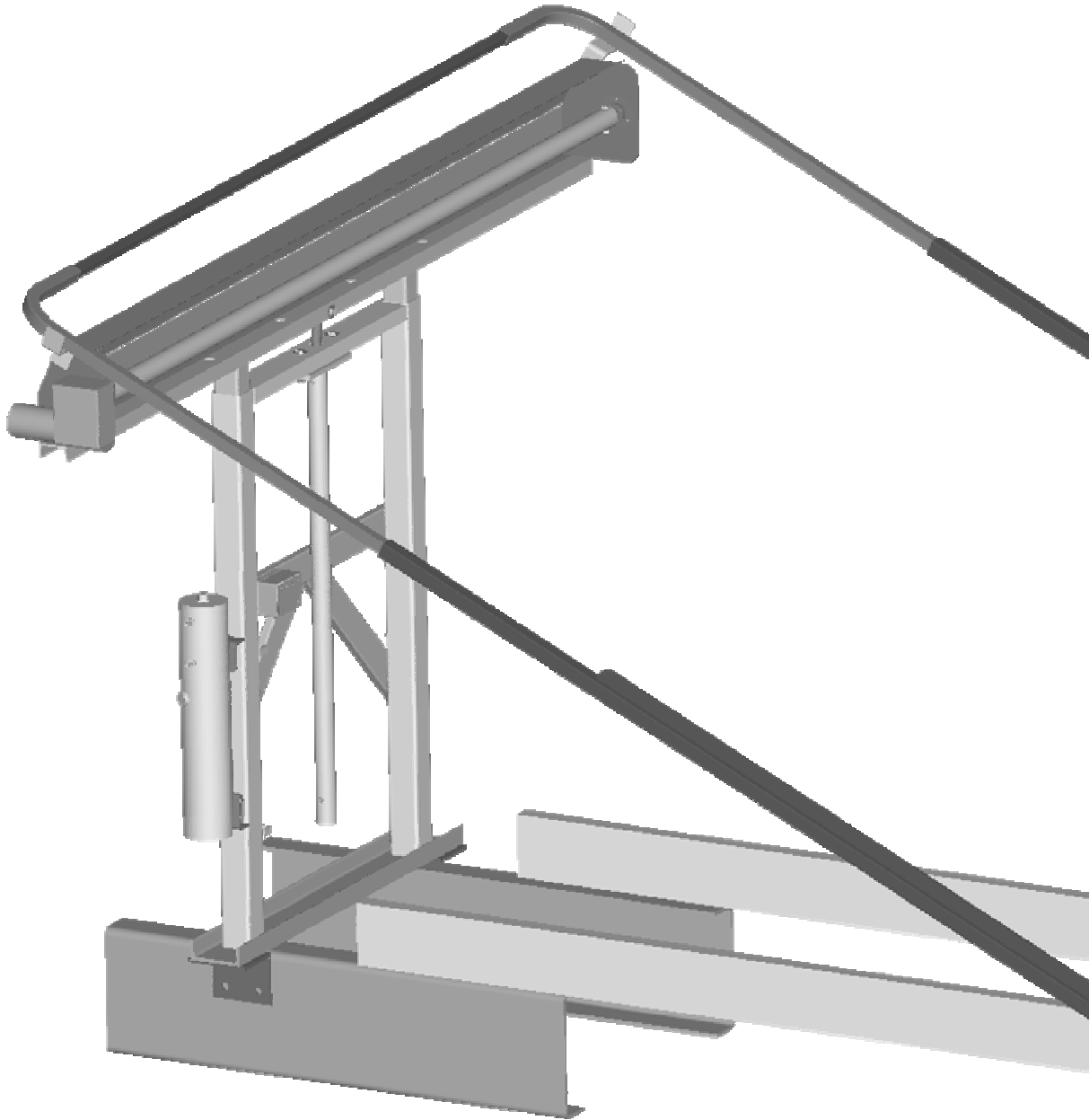

**SEPTEMBER 2008**

## REQUIRED PARTS

|   |                              |        |
|---|------------------------------|--------|
| 1 | TARP HOUSING                 | 1651   |
| 2 | PIVOT ARM REST               | 4362   |
| 1 | EXTRUDED ROLLER BAR ASSEMBLY | 2365   |
| 1 | 3/4" EXTENSION SHAFT         | 2838   |
| 1 | FLANGED BEARING, THREE BOLT  | 1752   |
| 1 | DIRECT DRIVE MOTOR           | 3880   |
| 1 | MOTOR COVER                  | 4040   |
| 1 | SOLENOID SWITCH              | 1497QF |
| 1 | TOGGLE SWITCH                | 4364   |
| 1 | SWITCH RUBBER BOOT           | 4365   |
| 1 | SWITCH HOUSING               | 4360   |
| 1 | PIVOT ARM, DRIVER            | 4338   |
| 1 | PIVOT ARM, CURB              | 4339   |
| 2 | ARM EXTENSION                | 1360   |
| 1 | REAR CROSS PIECE             | 1348   |
| 2 | PIVOT MOUNT                  | 1478   |
| 1 | SPRING TORSION, RIGHT        | 537    |
| 1 | SPRING TORSION, LEFT         | 427    |
| 4 | MOUNTING ANGLES              | 2347   |
| 4 | MOUNTING PLATES              | 4358   |
| 2 | WIRE, 4 GA, 16'              | 835    |

### MOTOR AND COVER HARDWARE

|   |                              |      |
|---|------------------------------|------|
| 3 | 5/16 X 3/4" HEX HEAD BOLT    | 3989 |
| 3 | 5/16 LOCK WASHER             | 2461 |
| 3 | 3/4 STEEL LOOP STRAP         | 2689 |
| 3 | 1/4" SELF DRILLING SCREW     | 3299 |
| 2 | # 10 X 3/8 SHEET METAL SCREW |      |

### HOUSING HARDWARE

|   |                          |      |
|---|--------------------------|------|
| 1 | 1/2-13 X 4" GRADE 8 BOLT | 2438 |
| 5 | 1/2-13 LOCK NUT          | 2877 |
| 6 | 1/2 FLAT WASHER          | 2878 |
| 4 | 5/16 X 3/4 BOLT          | 3839 |
| 4 | 5/16 FLAT WASHER         | 2867 |
| 4 | 5/16 NUT, LOCK           | 2461 |

ROLLER BAR HARDWARE

|   |                                     |      |
|---|-------------------------------------|------|
| 2 | 5/16 X 2-1/2" CARRIAGE BOLT GRADE 5 | 3237 |
| 2 | 5/16 LOCK NUT                       | 2868 |
| 2 | 5/16 FLAT WASHER                    | 2867 |
| 3 | 1/4 X 3/4" HEX HEAD BOLT            | 2421 |
| 3 | 1/4 LOCK NUT                        | 2316 |
| 3 | 1/4 FLAT WASHER                     | 2457 |

PIVOT MOUNT AND ARMS HARDWARE

|   |                             |      |
|---|-----------------------------|------|
| 6 | 1/4" X 3" COTTER PINS       | 2475 |
| 2 | 1" OIL IMPREGNATED BEARING  | 1665 |
| 4 | 1" FLAT WASHERS (2-1/2" OD) | 182  |
| 8 | 5/8 X 2-1/2 CARRIAGE BOLT   | 4363 |
| 8 | 5/8 LOCK NUT                | 4220 |
| 8 | 5/8 FLAT WASHER             | 4221 |

## ROLLER BAR AND DRIVE MOTOR MOUNTING

- 1) MOUNT THE DIRECT DRIVE MOTOR TO THE DRIVER SIDE OF THE TARP HOUSING USING 5/16" HEX HEAD BOLTS AND LOCK WASHERS SUPPLIED. SEE FIGURE 2.
- 2) INSTALL THE FLANGED BEARING TO THE INSIDE OF THE TARP HOUSING ON THE CURB SIDE WITH 1/4" CARRIAGE BOLTS, WASHERS AND LOCK NUTS SUPPLIED. SEE FIGURE 3.
- 3) DRILL A 5/16" HOLE, 1/2" FROM THE END OF THE ROLLER BAR THAT DOES NOT ALREADY HAVE A 5/16" HOLE. START THE HOLE IN ONE OF THE SMOOTH-SIDED SLOTS, **NOT** A THREADED SLOT.
- 4) SLIDE ONE END OF THE ROLLER BAR OVER THE DIRECT DRIVE MOTOR OUTPUT SHAFT AND SECURE WITH 5/16" GRADE 5 CARRIAGE BOLT, WASHER AND LOCKNUT SUPPLIED.
- 5) SLIDE THE EXTENSION SHAFT THROUGH THE BEARING AND INTO THE ROLLER BAR. LINE UP HOLES IN THE ROLLER BAR WITH THE HOLE IN THE EXTENSION SHAFT AND SECURE WITH THE 5/16 CARRIAGE BOLT, WASHER AND LOCKNUT SUPPLIED.

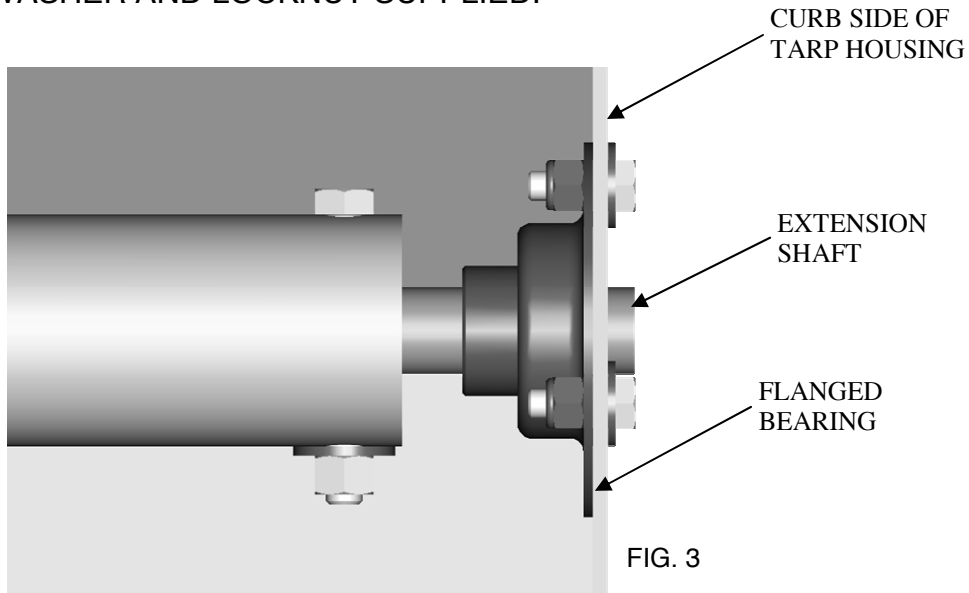
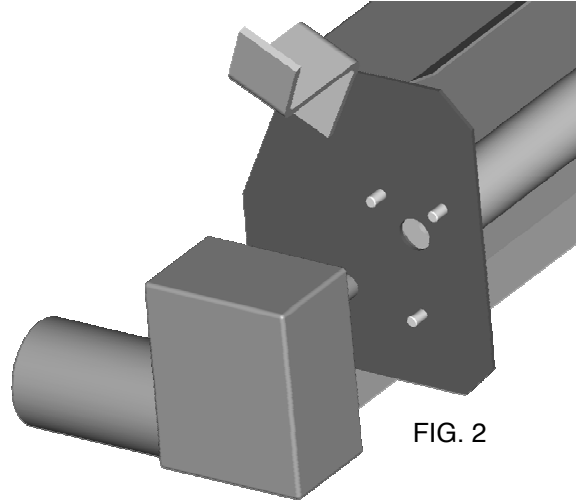

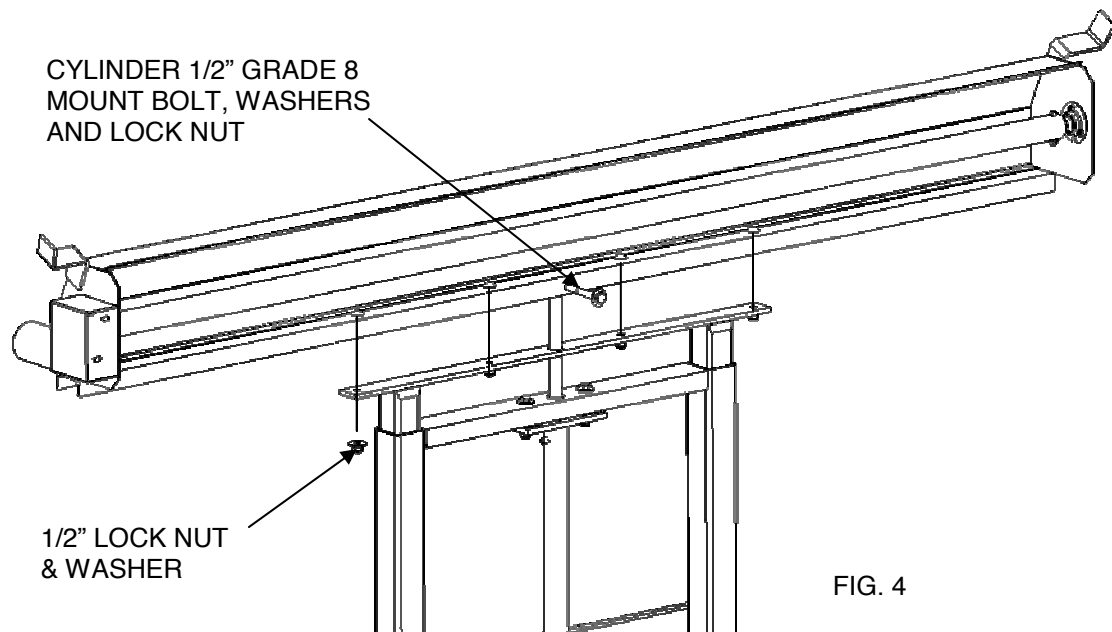

#### **TARP HOUSING MOUNTING**

- 1) MOUNT ROLLER BAR AND HOUSING TO THE LIFTING MECHANISM USING THE FOUR CHANNEL MOUNTING STUDS. ATTACH WITH FOUR 1/2" LOCKING NUTS AND WASHERS PROVIDED.
- 2) ATTACH THE HYDRAULIC CYLINDER ROD TO THE ROLLER BAR HOUSING WITH 1/2"-13 GRADE 8 BOLT, WASHERS AND NUT SUPPLIED.

**NOTE:** DEPENDING UPON THE BRAND AND CONDITION OF YOUR EXISTING TOWER (LIFTING MECHANISM) YOU MAY NEED TO WELD A SECTION OF STEEL FLAT BAR (MIN. ) TO THE TOP OF YOUR TOWER TO ALLOW ATTACHMENT OF THE TARP HOUSING.

**WIRING THE MOTOR:** FOLLOW THE INSTRUCTIONS SUPPLIED WITH YOUR ELECTRICAL SWITCH KIT.

## Installing Pivot Arm Mounts

1. LOCATE THE PIVOT ARM MOUNTS ON THE FENDERS APPROXIMATELY 144" FROM THE BACK OF THE LIFTING ASSEMBLY. PIVOT POINT MAY VARY BY TRUCK SIZE, USE THIS AS A STARTING POINT. SEE FIGURE 9

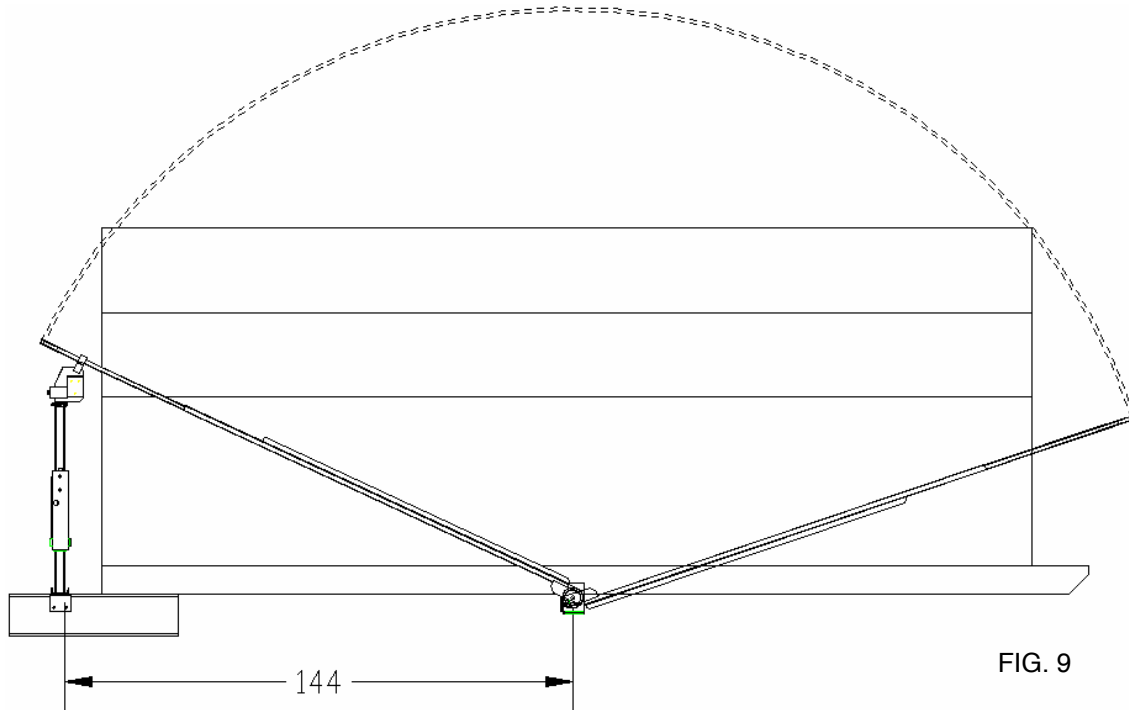

2. CENTER THE PIVOT MOUNTS A MAXIMUM OF 108" FROM OUTSIDE EDGE TO OUTSIDE EDGE. SEE FIGURE 10.

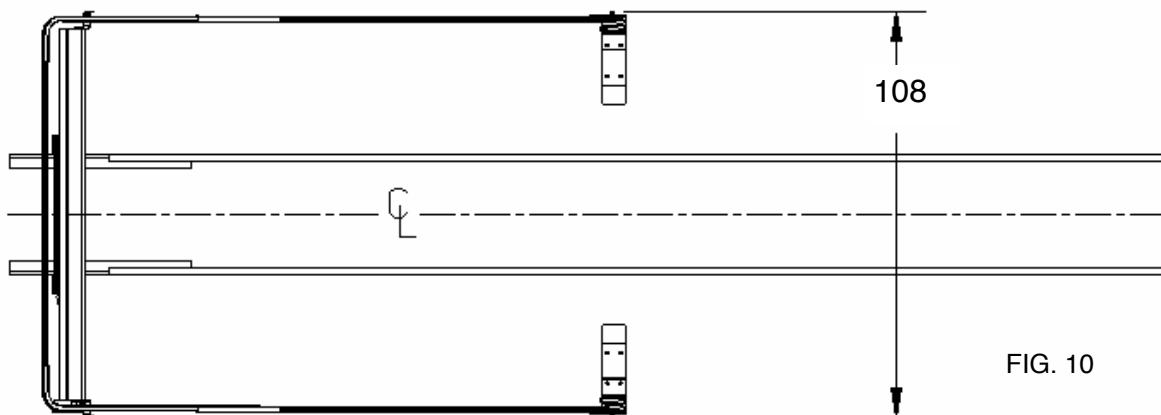

### Installing Pivot Arm Mounts Continued

3. USE MOUNTING PLATES AND SUPPLIED HARDWARE TO ATTACH THE PIVOT ARM MOUNT TO THE TRUCK FENDER. (NOTE: IF YOU HAVE PLASTIC FENDERS OR NO FENDERS PLEASE CALL (772) 286-3350 FOR TECHNICAL ASSISTANCE)

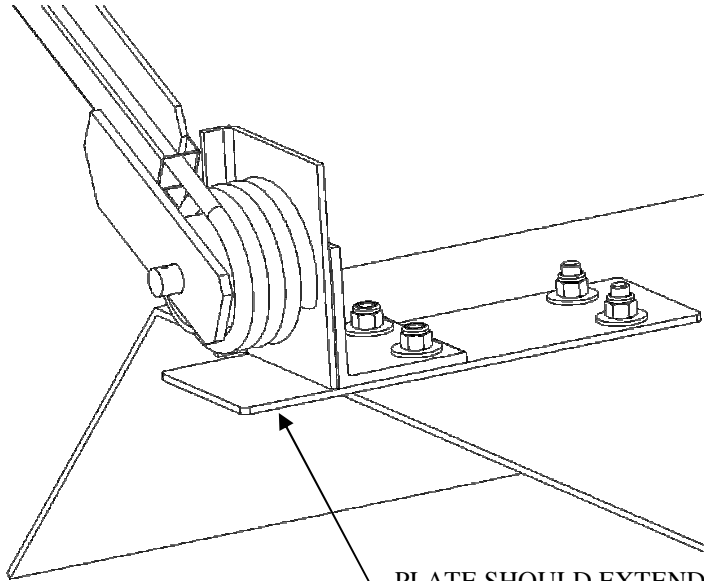

FIG. 11

PLATE SHOULD EXTEND BEYOND EDGE OF PIVOT MOUNT TO PREVENT ARMS FROM ROTATING BEYOND HORIZONTAL.

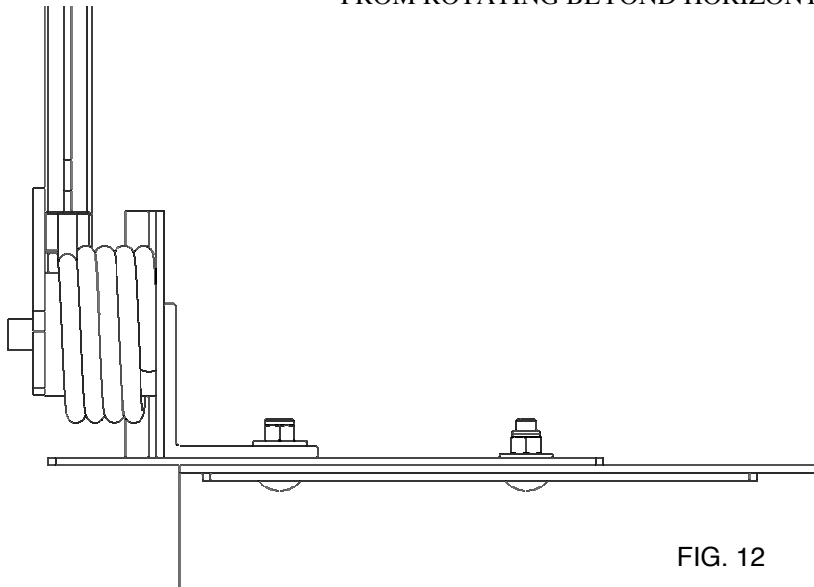
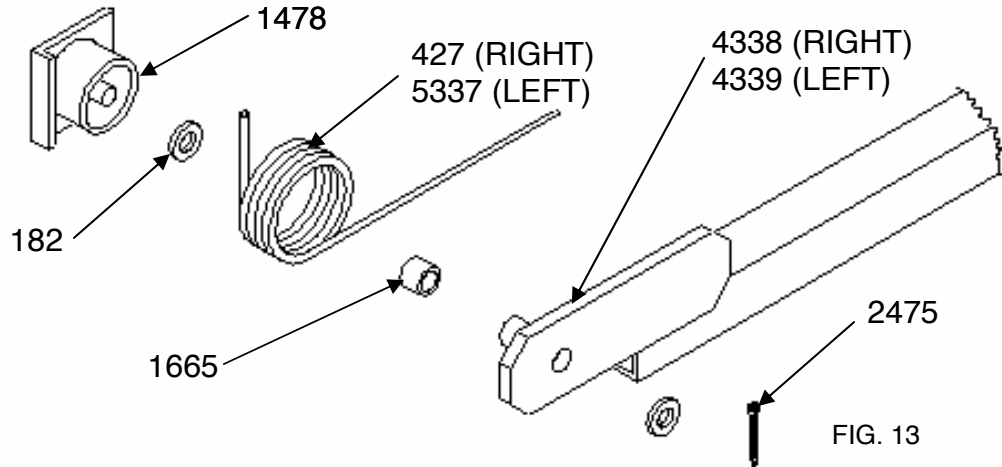

FIG. 12

## INSTALLING THE PIVOTS ARMS

1. ASSEMBLE THE LOWER ARM UNIT USING THE INCLUDED PIVOT MOUNT WASHERS, TORSION SPRINGS, BEARINGS, AND COTTER PINS. SEE FIGURE 13.



2. SLIDE ONE OF THE UPPER PIVOT ARMS INTO A LOWER ARM. ADJUST THE ARM LENGTH UNTIL THE CORNER RESTS ON THE DESIRED LANDING POINT AT THE BACK OF THE TRAILER AND AT THE HEAD ASSEMBLY.
3. SLIDE THE OTHER UPPER PIVOT ARM INTO THE LOWER PIVOT ARM (MAKE SURE THAT BOTH ARMS END UP THE SAME LENGTH).
4. DRILL ONE 1/4" HOLE THROUGH EACH LOWER ARM WHERE THE UPPER AND LOWER ARMS OVERLAP. SECURE THE UPPER AND LOWER ARMS USING THE COTTER PINS INCLUDED IN THE HARDWARE KIT. (MULTIPLE HOLES MAY BE DRILLED TO ALLOW FOR ADJUSTMENT IN ARM LENGTH.)
5. MEASURE THE DISTANCE BETWEEN THE UPPER ARMS AND CUT ONE END OF REAR CROSS PIECE 4" SHORTER THAN THE DISTANCE MEASURED. SEE FIGURE 14.
6. SLIDE THE ENDS OF THE REAR CROSS PIECE OVER THE UPPER PIVOT ARM ENDS.
7. DRILL A 1/4" HOLE THROUGH EACH END OF THE REAR CROSS PIECE AND UPPER ARM BENDS TO ALLOW THE REAR CROSS PIECE TO BE SECURED AFTER TARP INSTALLATION.

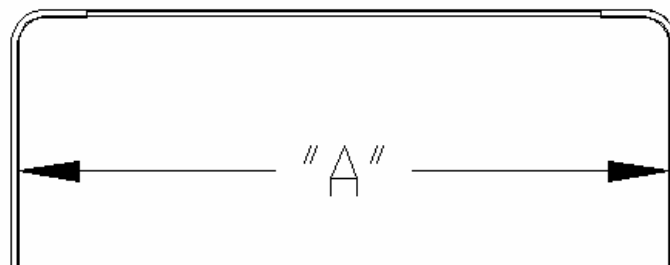

FIG. 14



### INSTALLING THE TARP

1. THREAD THE TARP SPLINE INTO THE SLOT IN THE CENTER OF THE ALUMINUM ROLLER BAR . (MAKE SURE TO REMOVE EXCESS SPLINE OR IT MAY HINDER THE SYSTEM'S OPERATION). SEE FIGURE 15.
2. THREAD THE TARP POCKET (SEWN INTO THE TARP) ONTO THE REAR CROSS PIECE.
3. CENTER THE TARP ON BOTH ALUMINUM ROLLER BAR AND REAR CROSS PIECE.
4. COTTER PIN THE REAR CROSS PIECE BACK ON TO THE 90° BEND IN THE UPPER ARM.

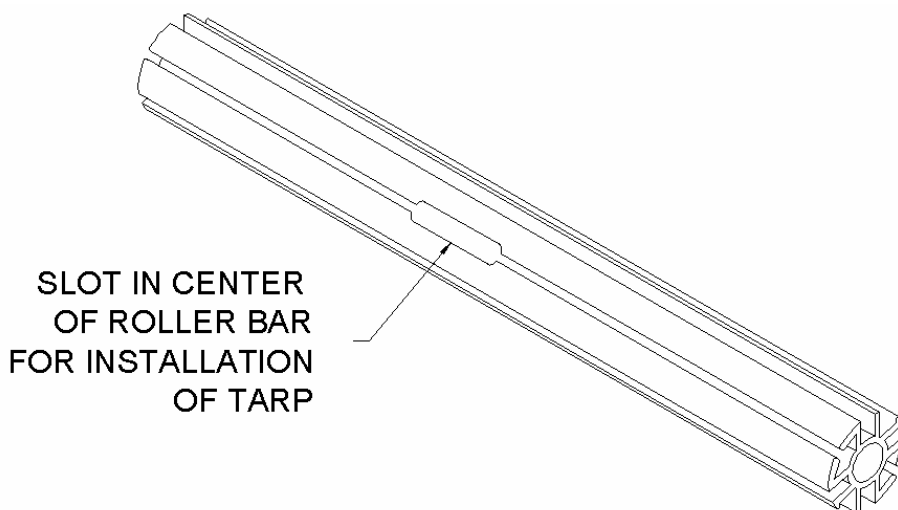

FIG. 15

5. TO WIND-UP THE TARP, THE TARP ROLLER BAR SHOULD SPIN COUNTER-CLOCKWISE VIEWING IT FROM THE DRIVER'S SIDE OF THE CAB. IF NOT, SWAP THE TWO WIRES WHERE THEY ARE CONNECTED TO THE DIRECT DRIVE MOTOR LEADS. IF ROLLER BAR ROTATES CLOCKWISE, ANY DEBRIS ON THE TARP WILL BE ROLLED UP IN IT AND POSSIBLY CAUSE DAMAGE.

### CAUTION

**ARMS MUST BE MORE THAN 15 DEG ABOVE HORIZONTAL BEFORE MOTOR CAN BE USED TO WIND UP THE TARP. FAILURE TO DO SO WILL CAUSE THE CIRCUIT BREAKER TO TRIP.**

